

TOTAL

One-Stop Tools Station

TOTAL

CORDLESS DRILL

TDLI200215



20V

Security instructions



Caution

Read all safety warnings and all instructions. Failure to follow all warnings and instructions can result in electric shock, fire, and / or serious injury.

The term “power tool” in the warnings refers to your mains-operated (corded) power tool or battery-operated (cordless) power tool.

Note: Save all warnings and instructions for future reference.

1) Work area safety

- a. Keep the work area clean and well lit to avoid accidents.
- b. Do not use power tools in explosive atmospheres, such as in the presence of flammable liquids, gases, or dust that can cause fires.
- c. Keep children and other unauthorized persons away while using a power tool. Distractions can cause you to lose control of the tool.

2) Electrical safety

- a. Power tool plugs must match the outlet. Never modify the plug in any way. Using a proper plug reduces the risk of electric shock.
- b. Avoid body contact with grounded surfaces such as pipes, radiators, ranges, and refrigerators. There is an increased risk of electric shock if your body is grounded.
- c. Do not expose power tools to rain or wet conditions. Water entering a power tool will increase the risk of electric shock.
- d. Never use the cord to carry, pull, or unplug the power tool. Keep the cord away from heat or oil.
- e. When using a power tool outdoors, use an extension cord suitable for outdoor use.
- f. If it is unavoidable to use the tool in a humid location, use a residual current device (RCD) protected supply to reduce the risk of electric shock.

3) Personal security

- a. Always be alert, watch what you are doing, and use common sense when operating the tool.
- b. Do not use a power tool if you are tired or under the influence of drugs or other substances.
- c. Use personal protective equipment. Always wear eye protection. Protective equipment such as a dust mask, non-slip safety shoes, hard hat, or hearing protection used in the right conditions will reduce personal injury. Also, do not wear loose clothing or jewelry.
- d. Avoid accidentally turning the tool on. Make sure the switch is in the off position before connecting it to the power supply and moving it.
- e. Remove any adjusting key or wrench before turning on the power tool. A wrench or wrench attached to a rotating part of the power tool can cause serious injury.
- f. If dust extraction and collection devices are used, make sure they are properly connected. Use these devices properly and you will reduce dust hazards.

4) Use and care of the cordless tool

- a. Recharge the battery only with the charger specified by the manufacturer. An unsuitable charger can create a fire hazard.
- b. Use power tools only with specifically designated batteries. The use of other batteries may create a risk of injury or fire.
- c. When batteries are not in use, keep it away from other metal objects, such as paper clips, coins, keys, nails, screws, or other small metal objects, that can make a connection from one terminal to another. Shorting the battery terminals together can cause burns or fire.
- d. Abusive conditions can cause liquid to eject from the battery; avoid contact. If accidentally contacted, rinse immediately with water. If the liquid comes into contact with the eyes, also seek medical help. Liquid expelled from the battery can cause irritation or burns.
- e. Do not use a battery or tool that is damaged or modified. They may exhibit unpredictable behavior resulting in fire, explosion, or risk of injury.
- f. Do not expose a battery or tool to fire or excessive temperature. Exposure to fire or a temperature above 130 ° C may cause an explosion.
- g. Follow all loading instructions. Do not charge the battery or the tool outside the temperature range specified in the instructions. Improper charging or at temperatures outside the specified range can damage the battery or increase the risk of fire.

5) Service

- a. Have your power tool repaired by a qualified person and use replacement parts recommended by the manufacturer. This will ensure that the safety of the power tool is maintained.

Safety rules for correct use



Double insulation for additional protection



Read the instruction manual before use.



CE conformity.



Wear safety glasses, hearing protection and a dust mask.



Waste electrical products must not be disposed of with household waste. Please recycle at the appropriate facilities. Check with your local authority or retailer for recycling advice.



Security alert. Use only accessories approved by the manufacturer.

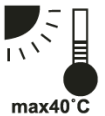

Charge the battery only below 40°C



Always recycle batteries



Do not expose the battery to fire or high temperatures



Do not expose battery to water

Additional safety warnings

Drill Safety Warnings

- Hold the tool by the insulated gripping surfaces when performing an operation where the cutting attachment may contact hidden wires.
- Cutting attachment coming into contact with a "live" wire can cause exposed metal parts of the power tool to "live" and could cause an electric shock to the operator.

Other risks

Even when the power tool is used as prescribed, it is not possible to eliminate all residual risk factors:

- a. Health defects resulting from the emission of vibrations if the power tool is used for a longer period of time or if it is not properly managed and maintained.
- b. Injury and property damage from broken accessories suddenly breaking.



Caution

This power tool produces an electromagnetic field during operation. This field can, in some circumstances, interfere with active or passive medical implants.

To reduce the risk of serious injury, we recommend that individuals with medical implants consult their physician before using this power tool.

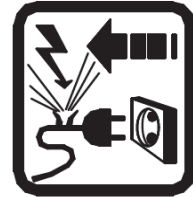

If the cord is damaged or cut during work, do not touch the cord, immediately unplug the tool. Never use the machine with a damaged cord.

The machine must not be damp and must not be used in a humid environment.



Attention

Safe working with this machine is only possible when the operating or safety information is fully read and the instructions contained therein are strictly followed.



Technical data

Data sheet	
Voltage	20V
Charging Voltage / Frequency	220-240V ~ 50 / 60Hz
Charging time	≅ 2 hours
Speeds	two
No-load speed	0-400 / 0-1500 / min
Torque settings	15 + 1
Maximum torque	45Nm
Keyless chuck capacity	10mm

Note: Due to the ongoing R & D & I program, this document is subject to change without notice.

Other warnings

Save these instructions



Attention

Do not let comfort or familiarity with the product (gained from repeated use) replace strict adherence to the safety rules for the product in question. Misuse or failure to follow the safety rules outlined in this instruction manual can cause serious personal injury.

Symbols

The symbols used for the tool are shown below.

Symbols	
V	Volts
— - - -	DC
n_0	No-load speed
... /min r /min	Revolutions per minute

Important Safety Instructions for the Battery Cartridge

1. Before using the battery, read all instructions and cautionary markings on:
 - a. The battery charger
 - b. Drums
 - c. Product.
2. Do not disassemble the battery cartridge.
3. If the operating time has been shortened excessively, stop using it immediately. It can result in overheating, possible burns, and even an explosion.
4. If electrolyte gets into your eyes, flush them with clean water and seek immediate medical attention. It can result in loss of sight.
5. Do not short-circuit the battery cartridge:
 - a. Do not touch the terminals with any conductive material
 - b. Avoid storing the battery cartridge in a container with other metal objects such as nails, coins, etc.
 - c. Do not expose the battery cartridge to water or rain.
Note: A short circuit in the battery can cause high current flow, overheating, possible burns, and even failure.
6. Do not store the tool or battery cartridge where the temperature can reach or exceed 50 ° C (122 ° F).
7. Do not incinerate the battery cartridge even if it is severely damaged or completely spent. The battery cartridge can explode in the event of a fire.
8. Be careful not to drop or hit the battery.
9. Do not use a damaged battery.
10. Follow local regulations regarding battery disposal.

Tips for Maintaining Maximum Battery Life

1. Charge the battery cartridge before it is completely discharged. Always stop operating the tool and charge the battery cartridge when you feel less power from the tool.

2. Never recharge a fully charged battery. Overcharging shortens the life of the battery.
3. Charge the battery cartridge at room temperature of 10 ° C to 40 ° C (50 ° F to 104 ° F). Allow a hot battery cartridge to cool down before charging.
4. Charge the battery cartridge if you do not use it for a long time (approx. More than six months).

Product description



Attention

Always make sure the tool is turned off and the battery cartridge removed before adjusting or verifying function on the tool.

Installing or removing the battery cartridge



Attention

Always turn the tool off before installing or removing the battery cartridge.

Hold the tool and battery cartridge firmly when installing or removing the battery cartridge. Failure to hold the tool and the battery cartridge can cause them to slip out of your hands and cause damage to the tool, battery cartridge, or even personal injury.



1. Battery button two. Battery cartridge

- To remove the battery cartridge, slide it out of the tool while sliding the button on the front of the cartridge.
- To install the battery cartridge, align the tab on the battery cartridge with the slot in the housing and slide it into place. Insert it fully until it clicks into place. If you can see the red indicator at the top of the button, it is not completely locked.



Attention

Always install the battery cartridge completely until the red indicator cannot be seen. Otherwise, you could accidentally fall off the tool and injure yourself or someone around you.

Do not install the battery cartridge forcibly. If the cartridge does not slide out easily, it is not being inserted correctly.

Indication of remaining battery capacity

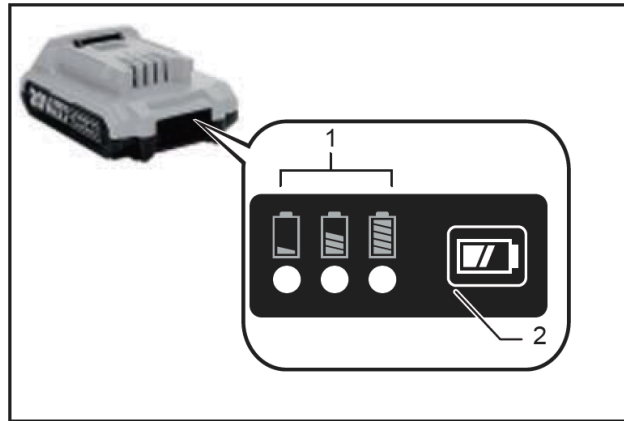

1. Indicator lights two. Check button

Press the check button on the battery cartridge to indicate the remaining battery capacity. The indicator lights come on for a few seconds.

Indicators		Remaining capacity
Switched on	Off	
■ ■ ■		> 80%
■ ■ □		30% to 80%
■ □ □		<30%

Note: Depending on the conditions of use and the ambient temperature, the indication may differ slightly from the actual capacity.

Switch actuation



1. Switch / trigger

To start the tool, simply squeeze the switch trigger. Tool speed increases by increasing pressure on the switch trigger. Release the switch trigger to stop.

Attention

Before inserting the battery cartridge into the tool, always verify that the switch trigger actuates properly and returns to the "OFF" position when released.



Electric brake

This tool is equipped with an electric brake. If the tool does not stop quickly after releasing the switch trigger, have the tool repaired at a TOTAL service center.

Illuminating the headlight



1. Light

- Squeeze the switch trigger to turn on the light.
 - This light remains on while the switch trigger is pulled.
 - It turns off 10-15 seconds after the trigger is released.

Note: Use a dry cloth to wipe dirt off the lens of the light. Be careful not to scratch it, as it may dim the lighting.



Attention

Do not look at the light directly.

Reversing switch action

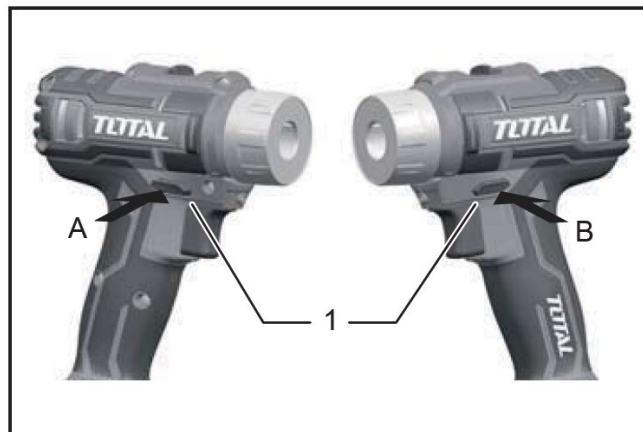

1. Reversing the switch lever

This tool has a reversing switch to change the direction of rotation.

- Press the reversing switch lever from side A to rotate clockwise
- Press from side B to rotate counterclockwise.
- When the reverse switch lever is in the neutral position, the switch trigger cannot be pulled.



Attention

Always check the direction of rotation before operation.

Use the reverse switch only after the tool has come to a complete stop. Changing the direction of rotation before the tool stops can damage the tool.

When not operating the tool, always place the reversing switch lever in the neutral position.

Fast change

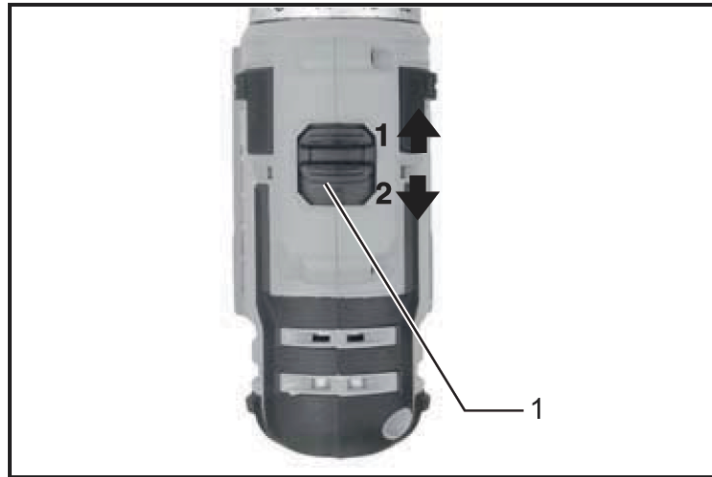

1. Gear shift lever

Gear shift lever position	Speed	Torque	Operation
1	Under	High	Heavy load operation
2	High	Under	Light load operation

- To change speed, turn tool off.
- Select side "2" for high speed
- Select "1" for low speed but high torque.

Note: Make sure the speed change lever is in the correct position before operation.

If the tool speed is extremely low during "2" operation, slide the lever to "1" and restart operation.





Attention

Always put the gearshift lever fully in the correct position. If you use the tool with the speed change lever positioned midway between the "1" side and the "2" side, the tool may be damaged.

Do not use the speed change lever while the tool is running. The tool can be damaged.

Setting the clamping torque

The tightening torque can be adjusted in 16 positions by turning the adjusting ring. Align the graduations with the arrow on the body of the tool. You can get the minimum tightening torque at 1 and the maximum torque at the mark .

The clutch will slip at various levels of torque when set to number 1 to 15. Clutch does not work at the mark .

Before actual operation, insert a trial screw into your material or a duplicate piece of material to determine what level of torque is required for a particular application.

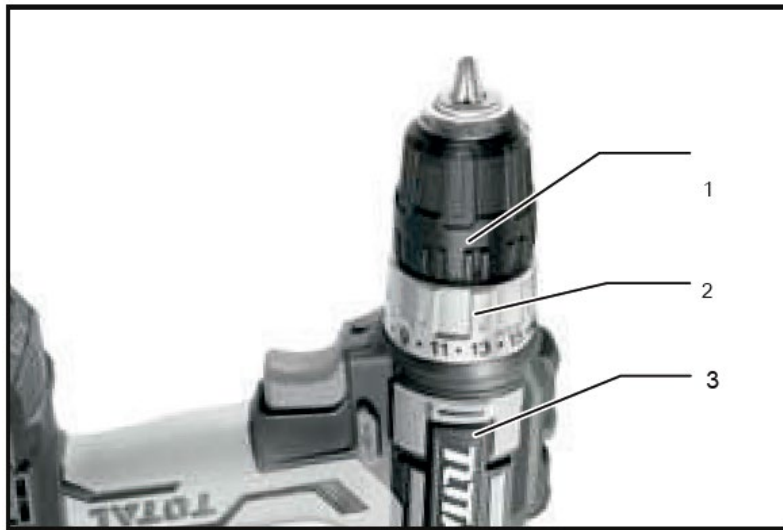

1. Adjusting ring 2. Graduation 3. Arrow

Mounting



Attention

Always make sure the tool is turned off and the battery cartridge removed before doing any work on the tool.

Bit Installation or Removal

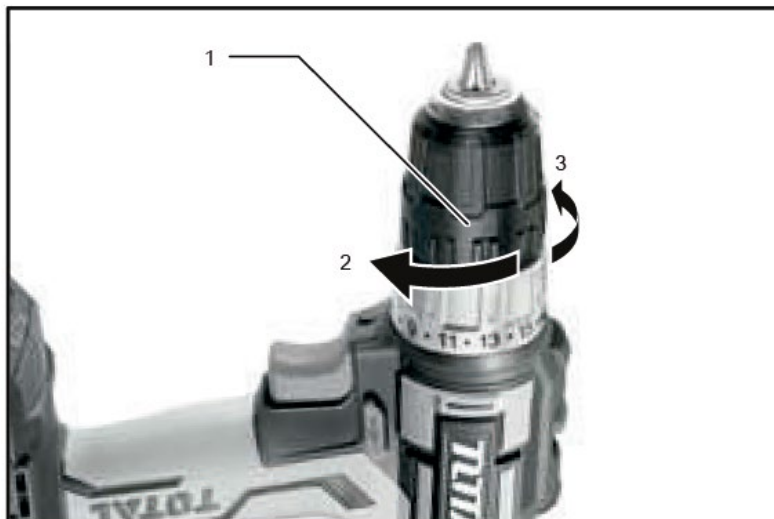

1. Sleeve 2. Close 3. Ablaugh

- Rotate the sleeve counterclockwise to open the chuck jaws.
- Place the bit in the chuck as far as it will go.
- Turn the sleeve clockwise to tighten the chuck.

- To remove the bit, turn the sleeve counterclockwise.

Start up



Attention

Always insert the battery cartridge all the way until it clicks into place. If you can see the red part at the top of the button, it is not completely locked.

Insert it all the way until the red part is no longer visible. Otherwise, you may accidentally fall off the tool, injuring yourself or someone around you.

Have one hand on the grip and the other hand on the bottom of the drum cartridge to control the twisting action.

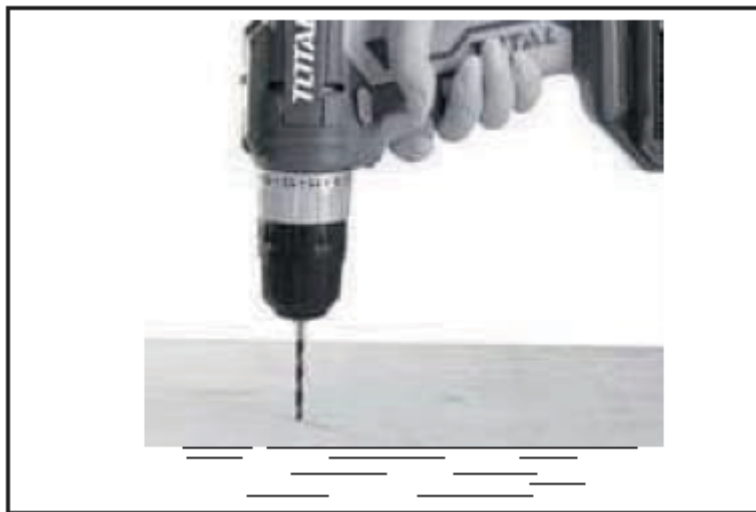

Screwing function

- Place the tip of the screwdriver bit on the screw head and apply pressure to the tool.
- Start the tool slowly and then gradually increase the speed.
- Release the switch trigger as soon as the clutch is engaged.

Note: When installing a wood screw, pre-drill a pilot hole 2/3 the diameter of the screw. Makes driving easier and prevents workpiece from splitting.



Caution

Adjust the adjusting ring to the proper torque level for your job.

Make sure the tip of the screwdriver is inserted directly into the screw head, or the screw bit and / or the drill bit could be damaged.

Drill operation

First, turn the adjusting ring so that the pointer points to the . Then proceed as follows.

Drilling in wood

When drilling in wood, the best results are obtained with wood bits equipped with a guide screw. The lead screw makes drilling easier by pulling the bit into the workpiece.

Drill in metal

To prevent the bit from slipping when starting a hole, make a dent with a center punch and hammer at the point to be drilled. Place the tip of the drill bit into the notch and begin drilling. Use a cutting lubricant when drilling metals. The exceptions are iron and brass which must be dry drilled.



Attention

- Pressing the tool excessively will not speed up the drilling. In fact, this excessive pressure will only serve to damage the tip of your bit, decrease tool performance, and shorten tool life.
- Hold the tool firmly and be careful when the bit begins to break the workpiece. A tremendous force is exerted on the tool / bit at the moment of hole breakage.
- A stuck bit can be removed simply by setting the reverse switch to reverse rotation to reverse. However, the tool can back off abruptly if you do not hold it firmly.
- Always secure small workpieces in a vise or similar clamping device.
- If the tool is used continuously until the battery cartridge has discharged, allow the tool to rest for 15 minutes before proceeding with a new battery.

Environment



- Do not dispose of electrical appliances as unsorted municipal waste, use separate collection facilities.
- Contact your local authority for information on available collection systems.
- If electrical appliances are disposed of in landfills, hazardous substances can seep into groundwater and enter the food chain, damaging your health and well-being.
- Recycle raw materials instead of disposing of them as waste.
- The machine, accessories and packaging must be classified for environmentally friendly recycling.

Exploded view

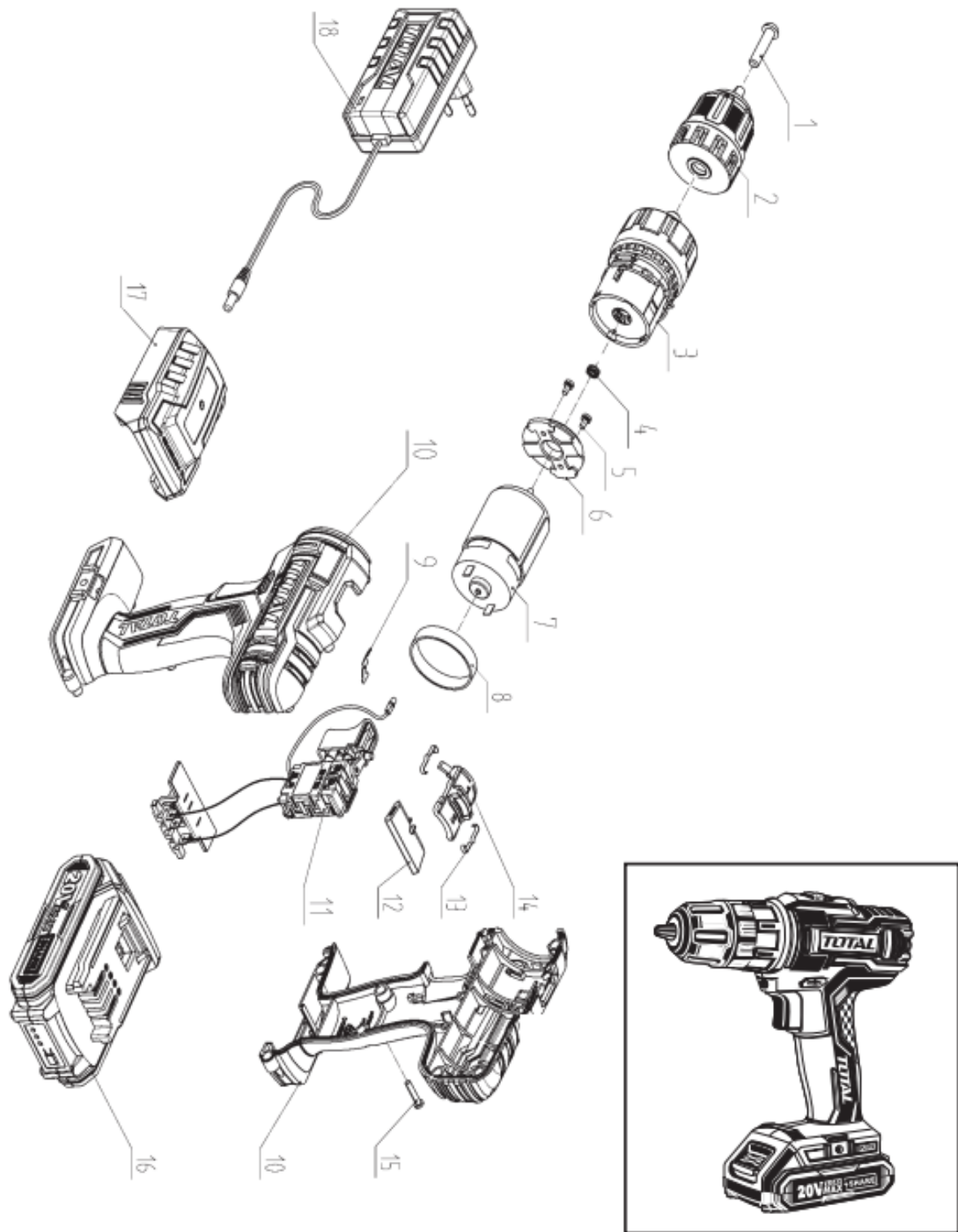

TOTAL

One-Stop Tools Station

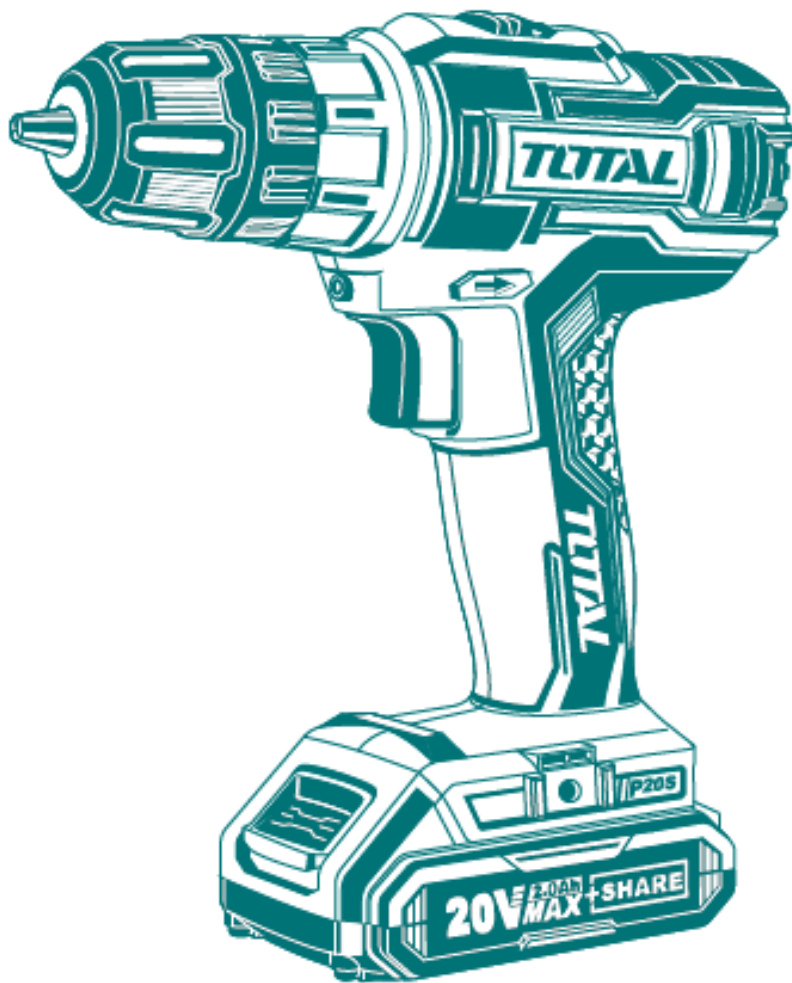

CORDLESS DRILL

20V